

Instruction Manual

Rekord 800



Introduction

Thank you for choosing a JUWEL Aquarium product.

Our products represent over 40 years experience in the manufacturing of aquariums and their accessories applying most modern production techniques bringing together the JUWEL Aquarium system, which is both easy to use and simple to maintain.

Important:

Please read this instruction manual carefully and completely to make sure you have received all components before setting up the aquarium.

Please observe the safety instructions and maintenance guidelines given in this manual.

This instruction manual has been carefully prepared to provide you with accurate and complete information. All efforts have been made to ensure that the information given is correct. However, we cannot accept responsibility for printing or other errors. Technical details are always approximate and are not warranted characteristics and may be subject to change without notice.

Always unplug all immersed electrical equipment from mains before placing your hands into the water.

Important:

The use of additional air stones or air lines is not necessary with the JUWEL Aquariums. If an air stone is used, this should always be placed in the middle of the aquarium. Capillary leaks resulting from the use of these items will not be accepted as a fault with the aquarium.

Do not transport or move your aquarium while still containing water or sand.

Always take care not to damage the seals while maintaining your aquarium.

Do not use toxic substances to clean your aquarium.

Safety instructions:

This appliance is not intended for use by persons (including children) with reduced physical, sensory or mental capabilities, or lack of experience and knowledge, unless they have been given supervision or instruction concerning use of the appliance by a person responsible for their safety. Children should be supervised to ensure that they do not play with the appliance.

 Operation with the RC circuit breaker only, max. 30mA.

 The power plugs of the electrical devices must not become moist. Connect the power plugs to the power supply at such a height that the connection cable forms a loop which would enable the water to drip down.

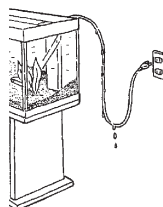

Setting up the Aquarium

We have produced your JUWEL Aquarium with the utmost care using most advanced production techniques. Extra strong packaging has been used to prevent damage to the aquarium. Please note however, that your aquarium has been transported and handled several times prior to reaching its final destination. We recommend therefore, that you test the aquarium for leaks in a suitable area (e.g. garage), by filling it with water and checking it very carefully.

Having made your checks, you should select the most suitable and desirable position for your aquarium. The position selected should have an even and level surface and should be able to support the weight of the filled aquarium. In order to prevent excessive algae growth, we recommend that you select a position that is not exposed to direct daylight.

We strongly recommend that the appropriate JUWEL Aquarium cabinet is used. They have a water-repellent surface and they have been made to match the dimensions and to bear the weight of the filled aquarium. The cabinet must be positioned on a level surface. The JUWEL Aquarium is built with a special bottom frame for security. The aquarium should be placed directly onto the cabinet. DO NOT place any additional support, e.g. polystyrene, under the aquarium since this is not necessary with our aquariums.

Weight of the aquarium in kg filled with water:
121

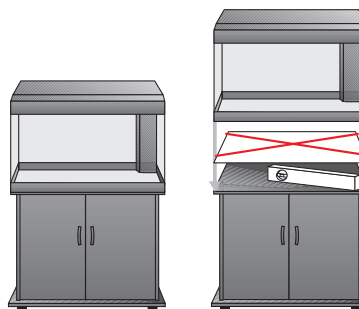

Suggestion: JUWEL Backgrounds

Complete the look of your aquarium by fitting one of our stunning backgrounds.

JUWEL Poster Backgrounds:

Vibrant plants or realistic rock on all double sided posters.

JUWEL Rock or Root Backgrounds:

Three dimensional Rock or Root backgrounds that give depth to the aquarium.

JUWEL Structured Backgrounds:

Subtle Bark effect that enhances the view of the aquarium.

JUWEL aquarium silicone:

The Rock, the Root and the Structured backgrounds are fitted to the inside of the aquarium using the JUWEL silicone prior to filling.

JUWEL Terrace

Attractive terrace modules matching the design of the backgrounds Rock and Root. All backgrounds are readily available from your JUWEL retailer.

Front



Back



Setting up your JUWEL Aquarium

In order to set up your aquarium and to prepare it for its intended use, please follow the following guidelines.

1. Make up the appropriate JUWEL Aquarium cabinet.
2. Place the aquarium in its chosen location.
3. Ensure that the filter system is set up according to the instructions as described in this manual.
4. Place your substrate in the bottom of the aquarium and plant as desired.
5. Fill the aquarium with room temperature water slowly through the filter to the red fill line indicated inside the aquarium - Important - do not over fill!
6. Connect the powerhead and heater and complete by placing the light unit and flaps on the top of the aquarium.
7. For tropical set-ups, allow the aquarium to reach the desired temperature prior to the addition of livestock.

You can add a few hardy fish after only a few days since you will need some livestock to start the filter maturation process. The filter can take between 6 and 8 weeks to fully mature. Should you choose to add further livestock during this period, then this should be a gradual process.

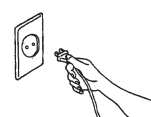
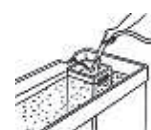
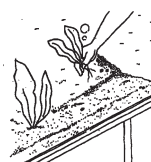
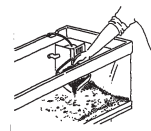
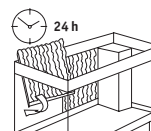
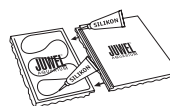

The JUWEL filter system Bioflow

The JUWEL filter system Bioflow is a highly effective biological filter system with two stages that includes components complementing each other in an ideal manner. Installing the filter in the aquarium makes hose connections unnecessary and prevents leaks. The pump output is not negatively affected by hose couplings, intake tubes etc. The capacity of the pump is designed in such a manner that an ideal level of biological filtering is ensured by a sufficient level of percolation through the filter material. In that context, the large filter volume ensures excellent mechanical filtering and facilitates long cleaning intervals.

The construction of the filter system enables you to quickly access the individual heater, pump, and filter media components. This way, the filter system may comfortably be operated during cleaning and while performing maintenance work.

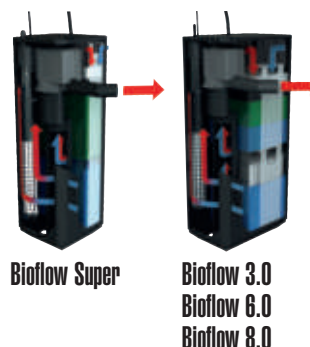

Pre-Filter Wool Pad (white)

The white filter wool acts as a mechanical pre-filter, removing large particles of dirt and excess food which in turn ensures that the other sponges do not get clogged.

Active Carbon Sponge (black)

The black activated carbon sponge sits on top of the blue coarse filter sponges, and removes chemical impurities from the water, which cannot be removed biologically.

Nitrate Removal Sponge (green)

The Sponge contains micro-organisms, which will, once developed, reside inside the sponges and in the water. These micro-organisms feed of nitrates and will reduce them significantly. The JUWEL Filtration system provides the optimum housing for these micro-organisms.

Filter Sponge Fine (blue)

The fine blue sponge and the bacteria cultures living in them, clean the water of even the smallest impurities. As the sponge has a very fine structure the water will flow through it even slower, allowing the bacteria even more time to perform their function.

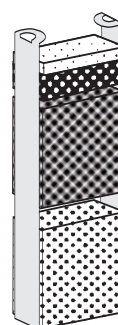

Getting Started - The JUWEL filter system Bioflow Super

You should prepare the filter for operation prior to setting up the aquarium. However, do not yet connect the electrical components to the power supply.

Please observe the following notes regarding commissioning the JUWEL filter system Bioflow Super:

The JUWEL filter system Bioflow Super consists of:

- 1 heater
- 1 heater holder
- 1 pump
- 1 white filter wool
- 1 carbon sponge, packaged
- 1 green nitrate remover sponge, packaged
- 1 blue filter sponge fine

1. Insert the base of the pump into the pump holder of the filter and firmly push it into position. In that context, the pump outlet faces in the direction of the nozzle opening. Confirm the proper arrangement of the gasket in the nozzle opening (it is used to minimize the transmission of vibrations).
2. Carefully attach the nozzle from the outside through the opening to the pump outlet and ensure its firm connection.
3. Insert the heater mount into the guide rail of the filter divider.
4. Insert the heater from above into the heater holder.
5. Now start preparing the filter sponges by removing the plastic packaging from the carbon sponge and the nitrate remover sponge. Thoroughly rinse the blue filter sponge only under running water.
6. After that, insert the blue filter sponge, the nitrate remover sponge, the carbon sponge and the filter wool on top into the filter basket and push it into the filter housing.
7. Place the filter cover on the filter housing.
8. The JUWEL filter system Bioflow Super is now ready for operation.

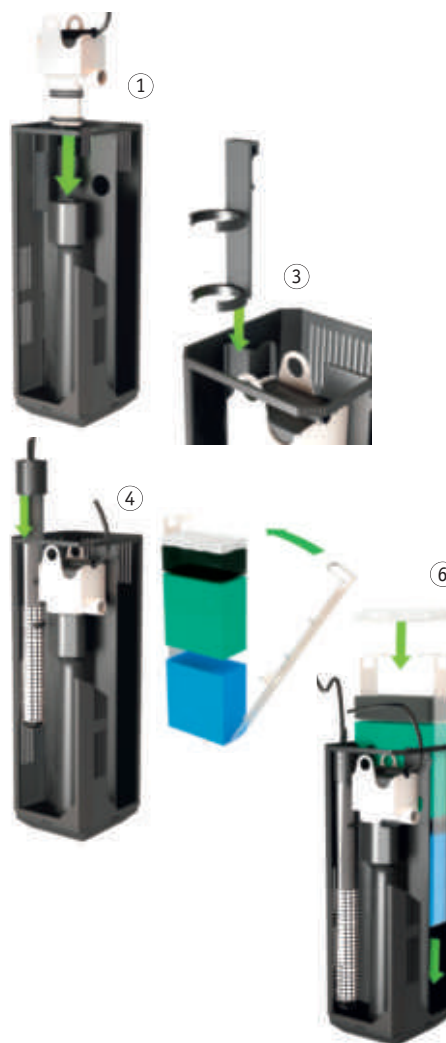

The JUWEL Aquarium Filter System is a biological filter system. For it to work effectively, bacteria cultures will need to grow inside the blue sponges. This process can take up 6-8 weeks for the filter to fully mature. Consequently we recommend to decorate and plant the aquarium and add just a few (3-5) hardy fish in order to help the maturation process. Please test the water on a weekly basis to monitor the water conditions and once the water is safe you can begin to add more fish.

Care and Maintenance of the JUWEL Filter System Bioflow Super

Care and maintenance of the JUWEL Filter System Bioflow Super is very easy and requires little time indeed, if you observe the following recommendations carefully:

- Replace the white pre-filter wool once a week. This will prevent dirt particles clogging the important blue sponges and having a negative effect on the important biological cultures.
- Replace the black carbon sponge every 4 weeks.

The black active carbon sponge removes chemical impurities and prevents these substances affecting the bacteria cultures inside the filter sponges. As with any active carbon sponge the absorption of these chemicals will only be effective for a defined period of time. Thereafter, the carbon will release the substances gradually back into the water. This is why we recommend changing these every 4 weeks.

- Replacing the white pre-filter wool and black carbon sponge as above ensures that the maintenance of the blue sponges is kept to a minimum. The biological system takes care of most of the work for you and we therefore suggest that you clean or replace these sponges every 3-6 months respectively. It is important to note that only one sponge should ever be cleaned or replaced at a time ensuring that a good supply of bacteria is available to maintain the aquarium's biological balance. Any cleaning or replacement destroys these good bacteria and they will need 10-14 days to recolonise the new sponges.

- In order to allow a proper level of micro-organisms in the filtration system it is recommended to exchange the sponge every 6 weeks. The nitrate removal sponge contains bacteria, which will after a while reduce the nitrate level in the aquarium significantly.



Important:

Always use original JUWEL Aquarium filter media to ensure the optimum performance of your system.



Maintaining the JUWEL Pump Bioflow

The JUWEL aquarium pump requires little maintenance. Regardless, you should confirm the functionality at regular intervals.

Please perform the following steps in order to test and maintain the pump:

1. Disconnect the pump and the heater from the power supply.
2. Remove the nozzles.
3. Remove the pump from the pump holder of the filter.
4. Remove the pump housing from the motor and remove the impeller.
5. Thoroughly clean all parts and particularly check the impeller for signs of wear at the magnet.
6. After that, please reinstall the pump in reverse order in the filter.

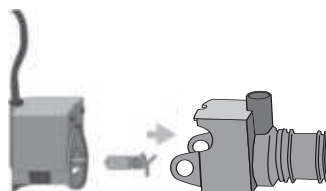

Recommendation:

In order to ensure that the power head operates at its optimum and maintains its low noise level, we recommend to check and potentially replace the parts subject to wear and tear, such as the impeller regularly.

All spare parts are available from your local JUWEL Aquarium retailer.

Safety instructions:

Never operate the power head out of water.

Always unplug the power head from the power supply before removing it from the filter.

The power head is intended for indoor use and for use in fluids up to 35°C.

Never repair the electrical cord or plug. In case of damage replace the complete power head.

Operation of the heater

The JUWEL aquarium heater is an essential component of the JUWEL filter system. Its positioning within the filter housing and consequently in the water stream facilitates even warming of the water in the aquarium.

You control the temperature of the water via the adjusting knob in the heater head. You may specify the temperature the heater is supposed to heat the water to in accordance with your individual requirements. The centre position between "+" and "-" corresponds to a water temperature of approximately 23 - 26 degrees Celsius or 74-78 degrees Fahrenheit.

Please note that depending on the starting temperature of the water in the aquarium, it may take approx. 12 hours and longer until the heater has heated the water to the desired temperature. After that, the heater will automatically keep the water at the desired temperature and switch on or off, accordingly. You recognise the operation of the heater via the red glow light.

We also recommend you to check the temperature of the water by means of a thermometer at regular intervals. The heater does not require further care or maintenance.

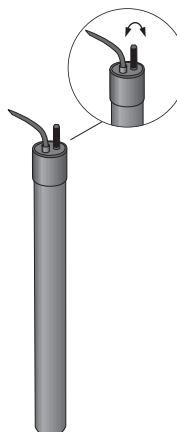

Recommendation:

The JUWEL automatic heater warms the water of your aquarium up to 28°C depending on a normal room temperature of 21°C. If you keep your aquarium in rooms below this or your fish need a higher temperature, we recommend to purchase a second heater.

Safety instructions:

Only connect the heater once the aquarium is filled with water at least to the minimum water level of the heater.

Never use the heater outside the aquarium.

Operate the heater indoors only.

Recommendation

JUWEL Digital Thermometer

To monitor the temperature we recommend the JUWEL Digital Thermometer (Part No. 85701). Available from your JUWEL Aquarium retailer.



Safety instructions:

Always unplug the heater and allow it to cool before removing it from the filter.

Never attempt to open or repair the heater. Any signs of damage or malfunction and the heater should be replaced with an original JUWEL Aquarium heater.

Never repair the electrical cord or plug. In case of damage replace the complete heater.

Once removed never place on a flammable surface.

This appliance is not intended for use by young children or infirm persons unless they have been adequately supervised by a responsible person to ensure that they can use the appliance safely. Young children should be supervised to ensure that they do not play with the appliance.

The cover lighting system JUWEL Duolux / Monolux

The cover light by JUWEL Aquarium enables you to achieve optimum lighting for your aquarium while enabling you to access the lit aquarium for general care at the same time.

The cover light itself is waterproof. Because of that, there is no need for cover panes against splash water that might negatively affect the luminosity.

The cover light by JUWEL Aquarium consists of

- waterproof protective cover (1)
- fluorescent tube/s (2)
- operating flap/s (4) for supplying feed and water care products etc.

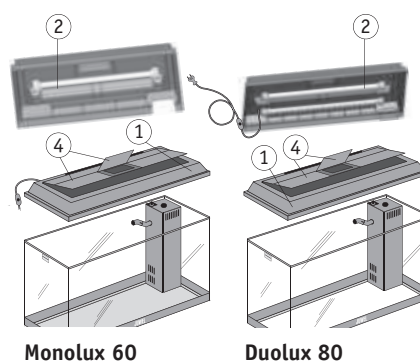

Set-up of the hood system

Please remove the hood from its protective cover.

In order to guarantee water tightness please ensure that the tube holders are fully tightened. This should be checked before connecting to the power supply.

Check that no sand or gravel is on the top edge of the aquarium and place the hood onto the aquarium. Connect the power supply and switch on the lamp using the In-line switch. Place the feeding flap in position to fully close the hood.

You may find it beneficial to connect the lights to a timer as plants benefit from a regular supply of light on a daily basis.

Safety instructions:

Never use the light system under water.

Never attempt to open the light unit or repair it. This is dangerous and will invalidate your warranty.

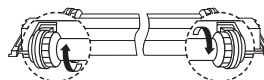

Care and Maintenance

The JUWEL Lighting cover requires very little care and attention. We recommend that you change your tubes on an annual basis. Although the tubes will be emitting light at this point their power has been drastically diminished by the number of starts they have made. Observing this procedure will give optimum output for your plants.

When replacing the tubes always replace both tubes and the tube holders which contain two vital seals to ensure water tightness.

Changing the Tubes

- Disconnect the hood system from the power supply (just switching off is not enough)
- Unscrew the tube holders and move them to the centre of the tube
- Remove the tube by pulling it gently towards you
- Place the new tube holders on the new tube
- Position the pins on the tubes in line with the slots on the tube holders and push the tube in until it clicks
- Tighten the new tube holders firmly to ensure a water tight seal
- Place the hood back on the aquarium and reconnect to the power supply and switch on

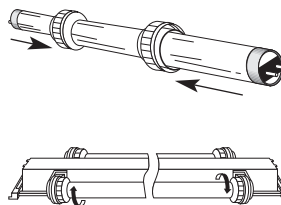

Safety instructions:

Always disconnect the light system from the power supply before changing the tubes.

Never repair the electrical cord or plug. In case of damage replace the complete light system.

Tip:

JUWEL automatic feeder

We offer you the JUWEL automatic feeder matching all JUWEL aquariums.

It is available from specialist retailers as original JUWEL Aquarium accessory (item No. 89000).



Recommendation:

JUWEL End Caps

To ensure the water tightness of your unit only use genuine JUWEL Aquarium spare parts.

Please note the tube holders are available from your local JUWEL Aquarium retailer (Part No. 92005).

Should you have difficulty in obtaining these please contact us directly.



Recommendation:

JUWEL Reflectors

We recommend the use of suitable JUWEL reflectors that you may purchase from retailers in order to improve the luminosity.

These increase the luminosity by 100% and consequently ensure a further improvement of the conditions within your aquarium.



Suggestion:

JUWEL Light Tubes

Genuine JUWEL light tubes are available from your JUWEL retailer in both the Day-Lite, Colour-Lite and Warm-Lite colours.





Proper disposal (electrical waste)

The labelling on the product or on the accompanying literature declares that it must not be disposed of, at the end of its service life, together with household rubbish. Please dispose of this equipment separately from other waste, to protect the environment or public health from damage by unregulated waste disposal. Recycle the equipment and support the sustained recycling of material resources.

Private users should contact the dealer who sold them the product or the responsible authorities, for a demonstration on how to recycle the equipment in an environmentally friendly way.

Guarantee

We guarantee the performance of the JUWEL-Aquarium product or its accessories to the purchaser for a period of 24 months from the date of purchase according to the following conditions:

§ 1 Extent of the guarantee

(1) This guarantee extends to the JUWEL-Aquarium product and its components excluding items subject to wear and tear such as light tubes and filter media. It is limited to the product as such and does not cover damage to other property and/or individuals. In addition, the provisions of the product liability law apply. These provisions are not limited by the aforementioned arrangement.

(2) It is the prerogative of JUWEL-Aquarium to decide whether the guarantee is performed by means of repair or replacement. If neither repair nor replacement can ensure the performance of the JUWEL-Aquarium product the purchaser is entitled to demand a reduction in price or to return the product against repayment of the purchase price.

§ 2 Guarantee period and settlement procedure

(1) The guarantee period begins on the day of the purchase of the product from the retailer. Claims under this guarantee will not be honoured, if

- (a) the damage is caused as a result of improper use or maintenance or non-observance of the instructions given in this manual
- (b) the product or its components have been maintained by persons or companies not authorised by the manufacturer to do so
- (c) the product or its components have been damaged by mechanical means of whatsoever kind, in particular broken glass

(2) All claims under this guarantee have to be notified to the retailer, from whom the aquarium has been purchased without delay, however, not longer than 2 weeks from the day of first occurrence of defects. Rights under the consumer protection laws will remain unaffected.

(3) Guarantee claims will only be accepted if the validity of the claim is supported by evidence of purchase of the JUWEL-Aquarium product.

This declaration of guarantee is a translation only. In case of doubts the original German language version prevails.

We reserve the right to make technical alterations.

© JUWEL AQUARIUM

© JUWEL, Trigon, Vision, Rekord, Rio, Lido, Vio, Korall, Monolux, Duolux, Multilux, Korallux, Violux, High-Lite, Warm-Lite, Colour-Lite, Day-Lite, Juwel Twin-Lite, Juwel Ecoflow, Bioflow, Cirax, Nitrax.

JUWEL FILTER SYSTEM BIOFLOW SUPER

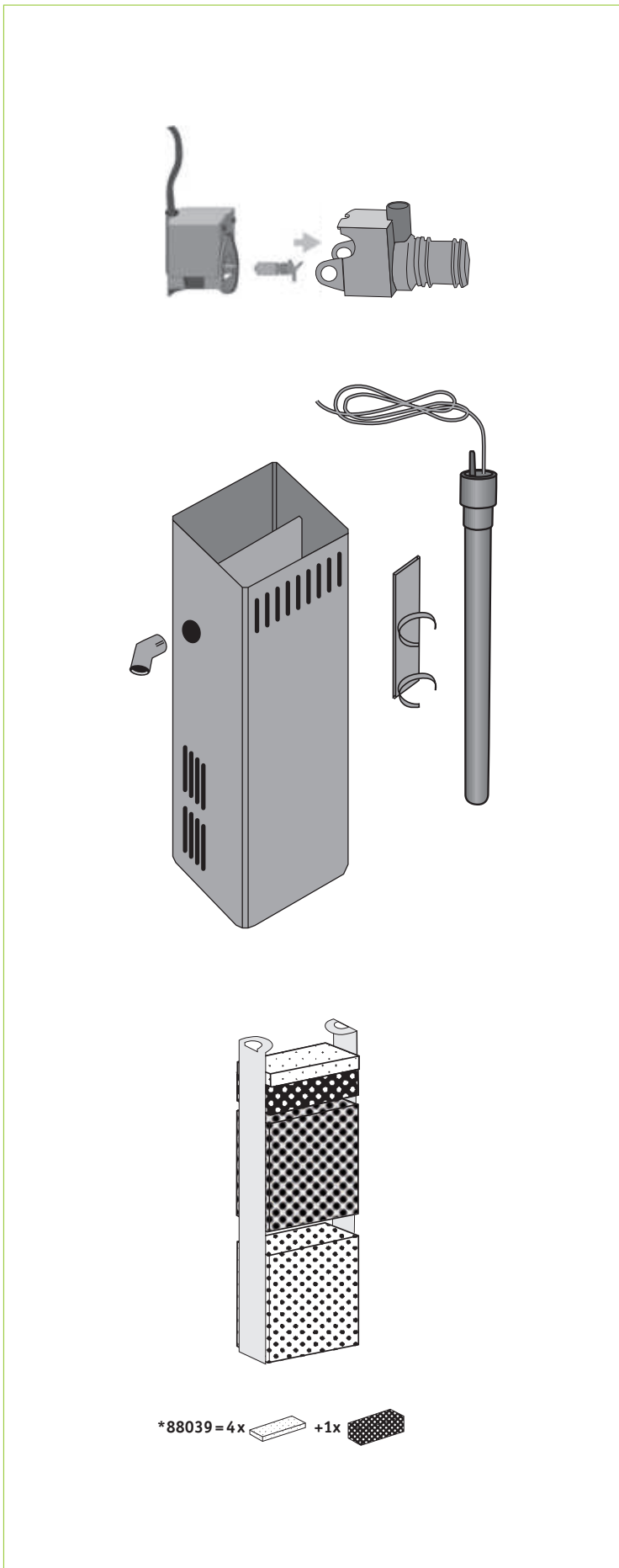

Artikel	Bestell-Nr.
	85071
	85605 85805 only GB 85855 only AU
	85502 85553 only GB 85575 only AU
	88055
	88051
	88056
	88039
	88038
	90046

